

MAXI STRINGER TRAILER MANUAL

Congratulations on your purchase of Agri Drain's Maxi Stringer Trailer.

Agri Drain is committed to providing high-quality products with fast, friendly service and we sincerely appreciate your business.

If you have any questions or comments about this or any other product we offer, please don't hesitate to call at 1-800-232-4742 or visit our website at www.agridrain.com.



Standard Maxi Stringer



Heavy Duty Tandem
Maxi Stringer



Agri Drain
CORPORATION

P.O. Box 458 • 1462 340th St. • Adair, IA 50002
Ph: 800-232-4742 • Fax: 800-282-3353
www.agridrain.com • info@agridrain.com  



**Know what's below.
Call before you dig.**
Within the US, Call: 811
www.call811.com

Limited Warranty, Limitations, Exclusions, Remedies and Disclaimers

Subject to the exclusions, limitations, disclaimers, limitations of remedy, and limitations of liability of this warranty, Agri Drain warrants that its manufactured products shall be free from defects in material and workmanship for the period of five (5) years from the date of purchase, with the exception of the below listed items.

Agri Drain warrants that trailers, custom or nonstandard items built to your specifications, 15" and 18" slide gate valves, and products installed in acid mine applications shall be free from defects in material and workmanship for the period of one (1) year from the date of purchase.

Except as set forth above, Agri Drain disclaims any liability for any products not manufactured by Agri Drain and purchaser is directed to the warranty, if any, provided by the manufacturer of such products. The obligations of Agri Drain, and the rights and remedies of purchaser set forth in this limited warranty are exclusive and in substitution for all other warranties, obligations and liabilities of Agri Drain. No other warranty is expressed and none shall be implied, including, without limitation, the warranty of merchantability or warranty of fitness for use or for a particular purpose.

Any Agri Drain product which has been damaged as a result of any testing, adjustments or modification that is contrary to any Agri Drain written instructions is not covered by this limited warranty. Any Agri Drain product which has been modified contrary to any Agri Drain written instructions is not covered by this limited warranty. Any Agri Drain product having a defect caused by neglect, accident, misuse, abuse, rental usage, use in a manner that is not normal or customary, or extraordinary use or maintenance is not covered by this limited warranty. No warranty is made that the Agri Drain product will meet your requirements or will work in combination with any products provided by third parties. Warranty does not apply to protective or cosmetic coatings. If a claim is made under this limited warranty and, after investigation by Agri Drain, proves to be valid, Agri Drain will, at its sole option, either repair or replace the Agri Drain products that do not conform to this limited warranty. Upon such a repair or replacement, the original remaining warranty period will continue in effect and be applicable to the repaired or replaced Agri Drain product. Except as expressly provided in this limited warranty to the contrary, Agri Drain shall not be obligated or liable for labor or other costs related to installation, repair, or replacement of any of its products or for loss of, or damage to, any material which is not sold by Agri Drain.

All claims and other communications under this limited warranty must be made to Agri Drain in writing and accompanied by a proof of purchase. Agri Drain shall have no liability whatsoever for special, indirect, consequential, incidental or exemplary damages under any circumstances, whether based on tort or breach of contract claims or on any other basis, to the full extent these damages may be disclaimed by law. The maximum liability of Agri Drain, if any, shall be limited to in all events, and shall not exceed the purchase price of the product upon which the claim of liability is made.

F.C.C. PART 15 INTENTIONAL RADIATOR MANUAL STATEMENT RADIO FREQUENCY INTERFERENCE STATEMENT

Note, this equipment has been tested and found to comply with the limits for an intentional radiator, pursuant to Part 15, subpart C of the F.C.C. Rules. This equipment generates uses and can radiate radio frequency energy. If not installed and used in accordance with the instructions, it may cause interference to radio communications.

The limits are designed to provide reasonable protection against such interference in a residential situation. However there is no guarantee that interference will not occur in a particular installation. If this equipment does cause interference to radio or television reception, which can be determined by turning the equipment on and off, the user is encouraged to try to correct the interference by one or more of the following measures:

- Reorient or relocate the receiving antenna of the affected radio or television.
- Increase the separation between the equipment and the affected receiver.
- Connect the equipment and the affected receiver to power outlets on separate circuits.
- Consult the dealer or experienced radio/TV technician for help.

MODIFICATIONS

Changes or modifications not expressly approved by the manufacturer could void the user's authority to operate the equipment.

Rev. 5/5/21

Operating Principle

Agri Drain offers the Maxi Stringer trailer in both Standard and Heavy Duty models. The Standard model is available in wireless remote or manual control, and single axle. The Heavy Duty model is available in wireless remote or manual control, and with single or tandem axle. All units are powered with an electric over hydraulic system that is located in the control box mounted at the front of the trailer. The trailer table is raised and lowered to load tile using these controls. The table rotates when stringing tile and a brake is used to keep the table from freewheeling.

Battery

A customer supplied 12-volt deep cell marine battery is recommended. Monarch pumps (remote trailer) require a minimum of 450 CCA (cold cranking amps). MTE pumps require a minimum of 250-300 CCA.

The life of the battery will vary, depending upon usage and charging level. If the trailer is equipped with a charging module (optional on the manual controlled unit, standard on the wireless remote), the battery in the trailer may be charged using the alternator of the towing vehicle. Details about the module are explained in the “Charging Module” section of this manual. Secure the battery in the control box using the battery hold down brackets. Connect the positive and negative cables to the battery. (See Fig. 1.)

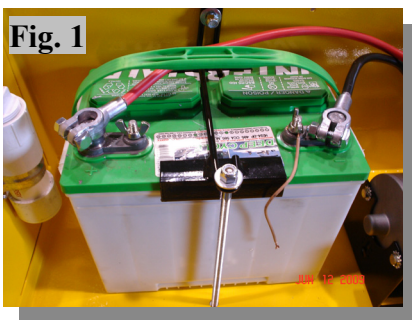

Charging Module

The charging module (optional on the manual controlled unit, standard on the wireless remote), is located in the control box near the battery. The module has three wires that need to be connected as set forth below.

The red wire with the ring terminal connects to the positive terminal of the battery. The black wire with the ring terminal connects to the negative terminal of the battery. The remaining red wire is routed to the wiring harness, and should be connected to the auxiliary or accessory pole on the connector being used. Verify that the wiring on the connector and the wiring of the vehicle match.

Note: Locate wire by function only. Color-coding is not standard among all vehicle manufacturers. For optimum charging, the auxiliary wire from the vehicle electrical system to the trailer hookup should be at least ten gauge. The module will charge the trailer battery when the vehicle engine is running and the alternator is putting out charge current.

A red LED light on the module will be lit when the trailer battery is being charged. The light may pulse on and off for a short period of time if the trailer battery voltage is low. When not charging, the vehicle and trailer batteries remain isolated.

Stinger

The stinger is used to stab the roll of tile. Install the standard stinger on the table using the eight bolts, washers, and nuts that are already in place. (See Fig. 2.) The Heavy Duty stinger is installed using the six holes located outside of the eight bolts holding the table to the center hub with the supplied bolts.



Holes (6 total) for Heavy Duty stinger.

Top Ring

The top ring is used to keep the tile in place while stringing. After loading the roll of tile, place the top ring on the stinger and secure it with the chain.

Maxi Spool

The maxi spool is an accessory that is used to store partial rolls of tile. When loading tile, first remove the stinger's top ring off the trailer. Next, stab the maxi spool with the trailer stinger. Remove the top ring of the maxi spool by releasing the locking mechanism and sliding it off the maxi spool. The locking mechanism is a spring loaded handle on the top ring that extends a tab through a slot in the maxi spool to lock it in place. Once the top ring has been removed, stab the roll of tile with the maxi spool, re-attach the top ring, and secure it with the locking mechanism.

Electric/Hydraulic-Manual

The manually controlled trailer is operated with a lever or pendant control on the hydraulic pump located in the control box. A label inside the control box displays what position the lever or pendant control must be in to raise and lower the table. (See Fig. 3.) The two battery cables attached to the hydraulic pump motor are marked positive and negative and should be connected to the battery accordingly.



Selector Valve-Remote

A selector valve is located on the back of the control box. The valve is used to direct the hydraulic oil flow to either the table tilt cylinder or the table brake. The valve should be pulled OUT for the transmitter to operate the table tilt and pushed IN to apply or release the table brake. (See Fig. 4.) Note: Care should be taken to unlock the tilt lock before raising the table. (See Fig. 7.)

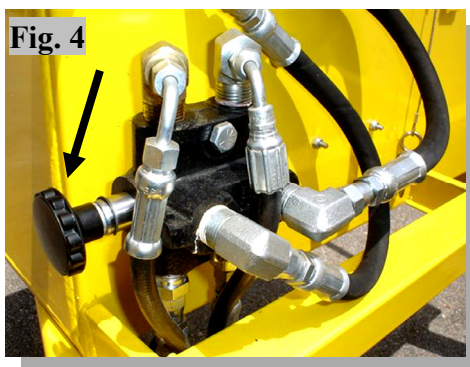

Electric/Hydraulic-Remote

The wireless remote control is available on all of our Maxi Stringer trailers. The transmitter has an “UP” button that will raise the table when pressed and a “DOWN” button that will lower the table. The transmitter will operate the pump from approximately a 100 foot radius and will only activate the pump on the trailer it is shipped with. The antenna is located on the back of the control box.

OPERATION: Depress the on/off button on the transmitter to activate. The blue light in the top right corner should turn on. The transmitter should be in the off position when the unit is not in use. This transmitter has a safety time-out feature. When the unit is inactive for 3 minutes, it automatically turns off. If this occurs, hit the on/off button to turn it back on. The switch located on the receiver module will function the same as the transmitter buttons.

If the battery needs recharged or replaced, or you add an additional transmitter, reprogramming will be required. Refer to the “HOW TO LEARN A TRANSMITTER” section on the information sheet supplied with the transmitter.

Manual Brake

The manual brake is standard on all manual trailers and consists of a positive locking, multi-position lever that can adjust the table from freewheeling to full brake. The brake presses against the table and slows the rotation of the table when stringing tile. The more pressure against the table, the slower it will rotate. (See Fig. 5.)

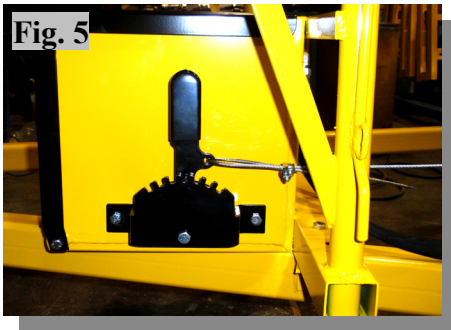

Remote Brake

The remote brake is activated with the transmitter when the selector valve is in the IN position. Pushing the “UP” button on the transmitter will extend the brake, pressing it against the table. To increase pressure, press the “UP” button; to release pressure, press the “DOWN” button.

Lights

Every trailer comes equipped with a lighting system that includes taillights, stoplights, turn signals, and a license plate lamp. This system requires a connection via the wiring harness to the tow vehicle electrical system. The white wire on the wiring harness is ground, the green wire is the right side stop and turn signal, the yellow wire is the left side stop and turn signal, the brown wire is the right and left tail lights, and the red wire, if present, is the auxiliary or accessory for the charging module. Note: Locate wire by function only. Color-coding is not standard among all vehicle manufacturers.

Loading/Transporting Tile

There are two locking mechanisms that must be in place when transporting tile. One locks the table in place so it cannot rotate. (See Fig. 6.)



One holds the table down so it cannot tilt up. (See Fig. 7.)

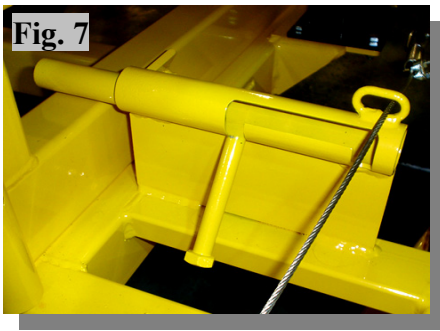

Warning: Failure to unlatch the table hold down lock prior to raising the table will result in structural damage to the trailer and will not be covered under our warranty.

There are two wings that can be in the up (extended/open) or down (folded under) position, depending on what is needed. The wings should be up when the trailer is loaded, and down when the trailer is empty. A shaft with handle and spring lock is used to lock and unlock the wings in position. When loading tile, rotate the table to the position where a wing is at the rear of the table and the lock that keeps the table from rotating can be locked into position. Slide the locking mechanism that keeps the table from rotating into place. Put the wing at the rear of the trailer in the down (folded under) position. (See Fig. 8.) Wings must be folded under and locked during transport between jobs and when transporting on public roads.



Caution: Raising the table with the wing in the up (extended) position could cause damage because the wing will hit the ground. Raise the table until the stinger lines up with the hole in the center of the tile to be loaded and back the trailer up until the table meets the tile. Install the top ring and secure the chain to the stinger. If a Maxi Spool is being used, refer to the “Maxi Spool” section in the manual. Lower the table all the way and slide the locking mechanism that keeps the table from tilting into place. Put the wing in the up position and lock it into place. (See Fig. 9.)



Rotate the table 90 degrees so that the bumper is at the rear of the trailer. Note: The bumper must be at the rear of the trailer when transporting on public roads. (See Fig. 10.) You are now ready to transport tile.

Fig. 10



Stringing Tile

To string tile, unlock the table rotate locking mechanism. Secure the end of the roll of tile at the point where the string is to start or end and pull the trailer in the opposite direction. The tile will unroll as the table rotates. Set the brake so that there is enough friction to keep the table from freewheeling. For braking instructions, refer to the “Manual Brake” or “Remote Brake” in the manual.

Caster Adjustment

If for any reason one of the four (4) table casters becomes damaged, it should be replaced at once to prevent damage to the table or table spindle. The casters are installed at approximately 45 degrees to the main frame to allow for rotation of the table. (See Fig. 11.)

Fig. 11

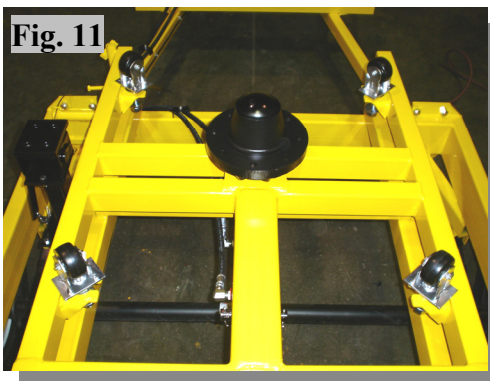

Clearance of $\frac{1}{4}$ " should be left between the caster and table to allow for any deviation of the table. It is important to securely lock the caster with the jam nut to prevent misalignment by becoming loose. (See Fig. 12.) Installation and adjustments to casters should be made with the table in the down (transport) position.

Fig. 12

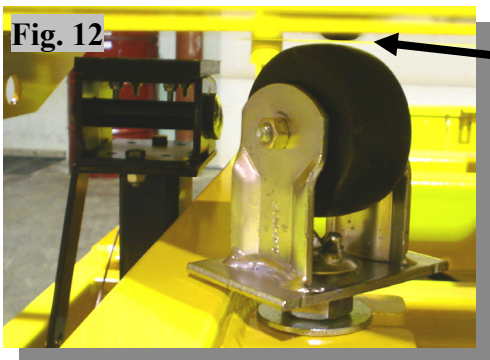

$\frac{1}{4}$ " Clearance

STANDARD SINGLE TRAILER

REF	QTY	DESCRIPTION	PART NO.
1	1	CHASSIS (LOWER)	700224
2	1	CHASSIS (UPPER)	700250
3	1	HUB ASSEMBLY (TABLE)	800139
4	4	CASTER	800071
5	1	CYLINDER	800090
6	1	BRAKE PAD, 1" (DATE OF MFG: 8/2009 OR NEWER)	701071
6A	1	BRAKE PAD, 1/2" (DATE OF MFG: 7/2009 OR OLDER)	701072
7	1	BRAKE ASSEMBLY (MANUAL)	700875
8	1	TAIL LIGHT W/ LICENSE WINDOW	800354
8A	1	TAIL LIGHT W/O LICENSE WINDOW	800353
9	2	RODS, PIVOT	700669
10	1	SPRING KIT	800173
11	1	HUB AND AXLE ASSEMBLY	800025
12	1	TONGUE (RH)	700252
13	1	TONGUE (LH)	700253
14	1	HITCH PLATE (TOP) (STANDARD)	700756
15	1	HITCH PLATE (BOTTOM) (STANDARD)	700757
16	1	JACK (10" LIFT)	800150
17	1	BATTERY / HYDRAULIC BOX	700478
18	1	PUMP, ELECTRIC / HYDRAULIC	800797
19	1	BATTERY HOLDOWN	700498
20	1	DOCUMENT HOLDER	700523
21	1	LID, HYDRAULIC / BATTERY BOX	700500
22	2	SPRING CAP	800835
23	1	ROD, TABLE ROTATE LOCK	700472
24	1	SAFETY LOCK	700581
25	1	BOLT / HANDLE	800056
26	1	ROD, CHASSIS TILT LOCK	700472
27	1	BOLT, HANDLE	800056
28	1	HANGER KIT (SINGLE AXLE)	800131
29	1	HYDRAULIC HOSE KIT (MANUAL)	800289
30	1	STINGER	700545
31	1	TABLE	700372
32	1	TABLE WING W/ BUMPER	700226
33	1	TABLE WING	700249
34	2	WING EXTENSIONS	700251
35	6	ROD, WING EXTENSION HINGE	700959
36	8	PLATE	700216A
37	2	BOLT, HANDLE	800056
38	2	WING LATCH PIN	700385
39	1	UPPER CYLINDER PIN	700669
40	1	BOLT (DATE OF MFG: 8/2014 OR OLDER)	700668
41	1	FLAT WASHER (DATE OF MFG: 8/2014 OR OLDER)	800385
42	1	HANDLE (DATE OF MFG: 8/2014 OR OLDER)	700666
43	1	SPRING (DATE OF MFG: 8/2014 OR OLDER)	800297
44	1	COTTER PIN (DATE OF MFG: 8/2014 OR OLDER)	800082
45	1	BRAKE STAND (MANUAL)	700869
46	1	BRAKE TENSION ASSEMBLY (MANUAL)	700938
47	1	BRAKE CABLE ASSEMBLY (MANUAL)	800794
51	1	IDENTIFICATION LIGHT BAR	800872
52	2	WING RELEASE PIN (DATE OF MFG: 9/2014 OR NEWER)	801157
53	1	BOX LATCH (DATE OF MFG: 2/2016 OR NEWER)	801256
FOR REMOTE OPTION, REFER TO TRAILER DRAWING FOR PART NOS.			

PICKUP MOUNT

REF	QTY	DESCRIPTION	PART NO.
2	1	CHASSIS (UPPER)	700250
3	1	HUB ASSEMBLY (TABLE)	800139
4	4	CASTER	800071
5	1	CYLINDER	800090
6	1	BRAKE PAD, 1" (DATE OF MFG: 8/2009 OR NEWER)	701071
6A	1	BRAKE PAD, 1/2" (DATE OF MFG: 7/2009 OR OLDER)	701072
7	1	BRAKE ASSEMBLY (MANUAL)	700875
9	1	ROD, PIVOT	700471
17	1	HYDRAULIC / BATTERY BOX (PICK-UP MOUNT)	700960
18	1	PUMP, ELECTRIC / HYDRAULIC	800797
19	1	BATTERY HOLDOWN	700498
21	1	LID, HYDRAULIC / BATTERY BOX	700500
23	1	ROD, TABLE ROTATE LOCK	700472
24	1	SAFETY LOCK	700581
25	1	BOLT / HANDLE	800056
29	1	HYDRAULIC HOSE KIT (MANUAL)	800289
30	1	STINGER	700545
31	1	TABLE	700372
33	2	TABLE WING	700249
34	2	WING EXTENSIONS	700251
35	6	ROD, WING EXTENSION HINGE	700959
36	8	PLATE	700216
37	2	BOLT, HANDLE	800056
38	2	WING LATCH PIN	700385
39	1	UPPER CYLINDER PIN	700669
45	1	BRAKE STAND (MANUAL)	700869
46	1	BRAKE TENSION ASSEMBLY (MANUAL)	700938
47	1	BRAKE CABLE ASSEMBLY (MANUAL)	800794
48	2	PLATE, PIVOT HINGE	700465
52	2	WING RELEASE PIN (DATE OF MFG: 9/2014 OR NEWER)	801157
53	1	BOX LATCH (DATE OF MFG: 2/2016 OR NEWER)	801256

HEAVY DUTY SINGLE TRAILER

REF	QTY	DESCRIPTION	PART NO.
1	1	CHASSIS (LOWER)	700225
2	1	CHASSIS (UPPER)	700250
3	1	HUB ASSEMBLY (TABLE)	800139
4	4	CASTER	800071
5	1	CYLINDER	800090
6	1	BRAKE PAD, 1" (DATE OF MFG: 8/2009 OR NEWER)	701071
6A	1	BRAKE PAD, 1/2" (DATE OF MFG: 7/2009 OR OLDER)	701072
7	1	BRAKE ASSEMBLY (MANUAL)	700875
8	1	TAIL LIGHT W/ LICENSE WINDOW	800354
8A	1	TAIL LIGHT W/O LICENSE WINDOW	800353
9	2	RODS, PIVOT	700669
10	1	SPRING KIT	800173
11	1	HUB AND AXLE ASSEMBLY	800025
12	1	TONGUE (RH)	700892
13	1	TONGUE (LH)	700891
14	1	HITCH HD SINGLE	700911
15	1	CHANNEL, BOLTS AND CLEVIS	800775
16	1	JACK (15" LIFT)	800411
17	1	BATTERY / HYDRAULIC BOX	700478
18	1	PUMP, ELECTRIC / HYDRAULIC	800797
19	1	BATTERY HOLDOWN	700498
20	1	DOCUMENT HOLDER	700523
21	1	LID, HYDRAULIC / BATTERY BOX	700500
22	2	SPRING CAP	800835
23	1	ROD, TABLE ROTATE LOCK	700472
24	1	SAFETY LOCK	700581
25	1	BOLT / HANDLE	800056
26	1	ROD, CHASSIS TILT LOCK	700472
27	1	BOLT, HANDLE	800056
28	1	HANGER KIT (SINGLE AXLE)	800131
29	1	HYDRAULIC HOSE KIT (MANUAL)	800289
30	1	STINGER	700895
31	1	TABLE	700372
32	1	TABLE WING W/ BUMPER	700226
33	1	TABLE WING	700249
34	2	WING EXTENSIONS	700251
35	6	ROD, WING EXTENSION HINGE	700959
36	8	PLATE	700216A
37	2	BOLT, HANDLE	800056
38	2	WING LATCH PIN	700385
39	1	UPPER CYLINDER PIN	700669
40	1	BOLT (DATE OF MFG: 8/2014 OR OLDER)	700668
41	1	FLAT WASHER (DATE OF MFG: 8/2014 OR OLDER)	800385
42	1	HANDLE (DATE OF MFG: 8/2014 OR OLDER)	700666
43	1	SPRING (DATE OF MFG: 8/2014 OR OLDER)	800297
44	1	COTTER PIN (DATE OF MFG: 8/2014 OR OLDER)	800082
45	1	BRAKE STAND (MANUAL)	700869
46	1	BRAKE TENSION ASSEMBLY (MANUAL)	700938
50	1	BRAKE CABLE ASSEMBLY (MANUAL)	800794
51	1	IDENTIFICATION LIGHT BAR	800872
52	2	WING RELEASE PIN (DATE OF MFG: 9/2014 OR NEWER)	801157
53	1	BOX LATCH (DATE OF MFG: 2/2016 OR NEWER)	801256
FOR REMOTE OPTION, REFER TO TRAILER DRAWING FOR PART NOS.			

HEAVY DUTY TANDEM TRAILER

REF	QTY	DESCRIPTION	PART NO.
1	1	CHASSIS (LOWER)	700906
2	1	CHASSIS (UPPER)	700250
3	1	HUB ASSEMBLY (TABLE)	800139
4	4	CASTER	800071
5	1	CYLINDER	800090
6	1	BRAKE PAD, 1" (DATE OF MFG: 8/2009 OR NEWER)	701071
6A	1	BRAKE PAD, 1/2" (DATE OF MFG: 7/2009 OR OLDER)	701072
7	1	BRAKE ASSEMBLY (MANUAL)	700875
8	1	TAIL LIGHT W/ LICENSE WINDOW	800354
8A	1	TAIL LIGHT W/O LICENSE WINDOW	800353
9	2	RODS, PIVOT	700669
10	2	SPRING KIT	800173
11	2	HUB AND AXLE ASSEMBLY	800025
12	1	TONGUE (RH)	700893
13	1	TONGUE (LH)	700894
14	1	HITCH HD TANDEM	700912
15	1	CHANNEL, BOLTS AND CLEVIS	800775
16	1	JACK (15" LIFT)	800411
17	1	BATTERY / HYDRAULIC BOX	700478
18	1	PUMP, ELECTRIC / HYDRAULIC	800797
19	1	BATTERY HOLDOWN	700498
20	1	DOCUMENT HOLDER	700523
21	1	LID, HYDRAULIC / BATTERY BOX	700500
22	2	SPRING CAP	800835
23	1	ROD, TABLE ROTATE LOCK	700472
24	1	SAFETY LOCK	700581
25	1	BOLT / HANDLE	800056
26	1	ROD, CHASSIS TILT LOCK	700472
27	1	BOLT, HANDLE	800056
28	2	HANGER KIT (TANDEM AXLE)	800131
29	1	HYDRAULIC HOSE KIT (MANUAL)	800289
30	1	STINGER	700895
31	1	TABLE	700372
32	1	TABLE WING W/ BUMPER	700226
33	1	TABLE WING	700249
34	2	WING EXTENSIONS	700251
35	6	ROD, WING EXTENSION HINGE	700959
36	8	PLATE	700216A
37	2	BOLT, HANDLE	800056
38	2	WING LATCH PIN	700385
39	1	UPPER CYLINDER PIN	700669
40	1	BOLT (DATE OF MFG: 8/2014 OR OLDER)	700668
41	1	FLAT WASHER (DATE OF MFG: 8/2014 OR OLDER)	800385
42	1	HANDLE (DATE OF MFG: 8/2014 OR OLDER)	700666
43	1	SPRING (DATE OF MFG: 8/2014 OR OLDER)	800297
44	1	COTTER PIN (DATE OF MFG: 8/2014 OR OLDER)	800082
45	1	BRAKE STAND (MANUAL)	700869
46	1	BRAKE TENSION ASSEMBLY (MANUAL)	700938
50	1	BRAKE CABLE ASSEMBLY (MANUAL)	800794
51	1	IDENTIFICATION LIGHT BAR	800872
52	2	WING RELEASE PIN (DATE OF MFG: 9/2014 OR NEWER)	801157
53	1	BOX LATCH (DATE OF MFG: 2/2016 OR NEWER)	801256
FOR REMOTE OPTION, REFER TO TRAILER DRAWING FOR PART NOS.			

PART NO.	REV.	CO. AGRI DRAIN CORP.	MATERIAL:
----------	------	----------------------	-----------

REVISIONS			
REV	DESCRIPTION	DATE	BY

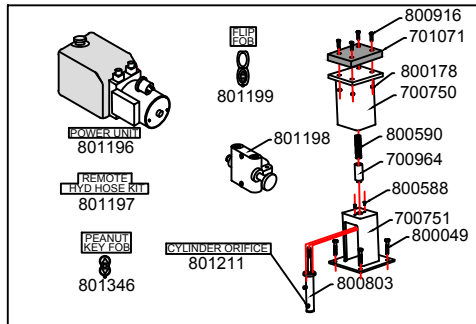

REMOTE OPTION

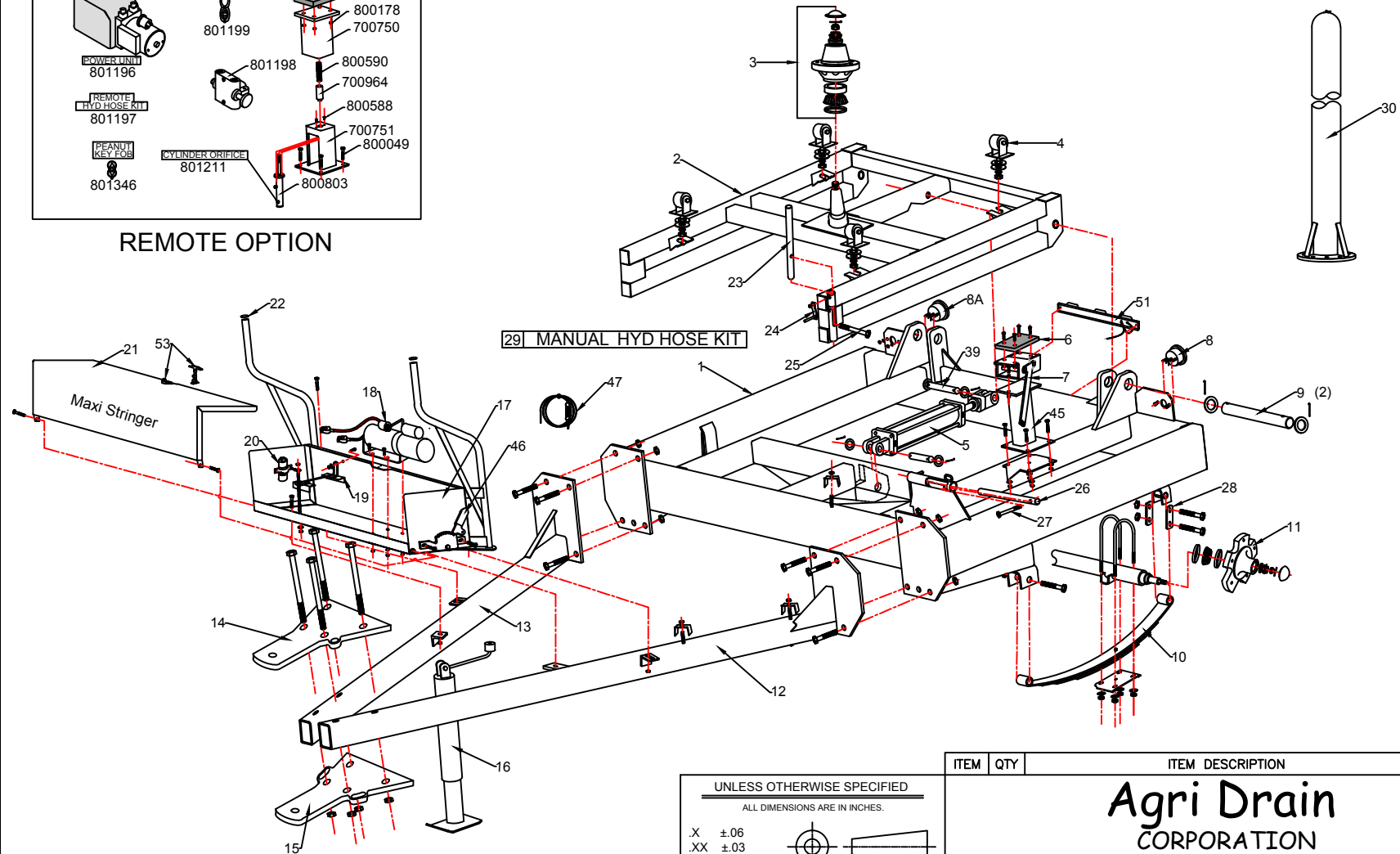

UNLESS OTHERWISE SPECIFIED
ALL DIMENSIONS ARE IN INCHES.

.X ±.06
.XX ±.03
.XXX ±.010
ANGLES ±2°

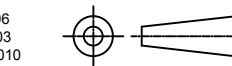

BREAK ALL SHARP CORNERS.

ALL INFORMATION CONTAINED IN THIS DOCUMENT IS PROPRIETARY TO AGRI DRAIN CORP. DUPLICATION OR TRANSMITTAL OF THIS DOCUMENT IS STRICTLY PROHIBITED WITHOUT THE WRITTEN CONSENT OF AGRI DRAIN CORP.

ITEM	QTY	ITEM DESCRIPTION	PART NO.
<p>Agri Drain CORPORATION</p> <p><i>America's Most Complete Supplier of Water Management Products</i></p> <p>P.O. Box 458 - 1462 340th St. - Adair, IA 50002 - Ph: 1-800-232-4742 - Fax 1-800-282-3353 - www.agridrain.com</p>			
<p>TITLE</p> <p>STANDARD, SINGLE TRAILER PARTS</p>			
DATE: 1JUL09	DRAWN BY: J MOORE	PART NO.	REV.

PART NO.	REV.	CO. AGRI DRAIN CORP.	MATERIAL:	REVISIONS			
				REV	DESCRIPTION	DATE	BY

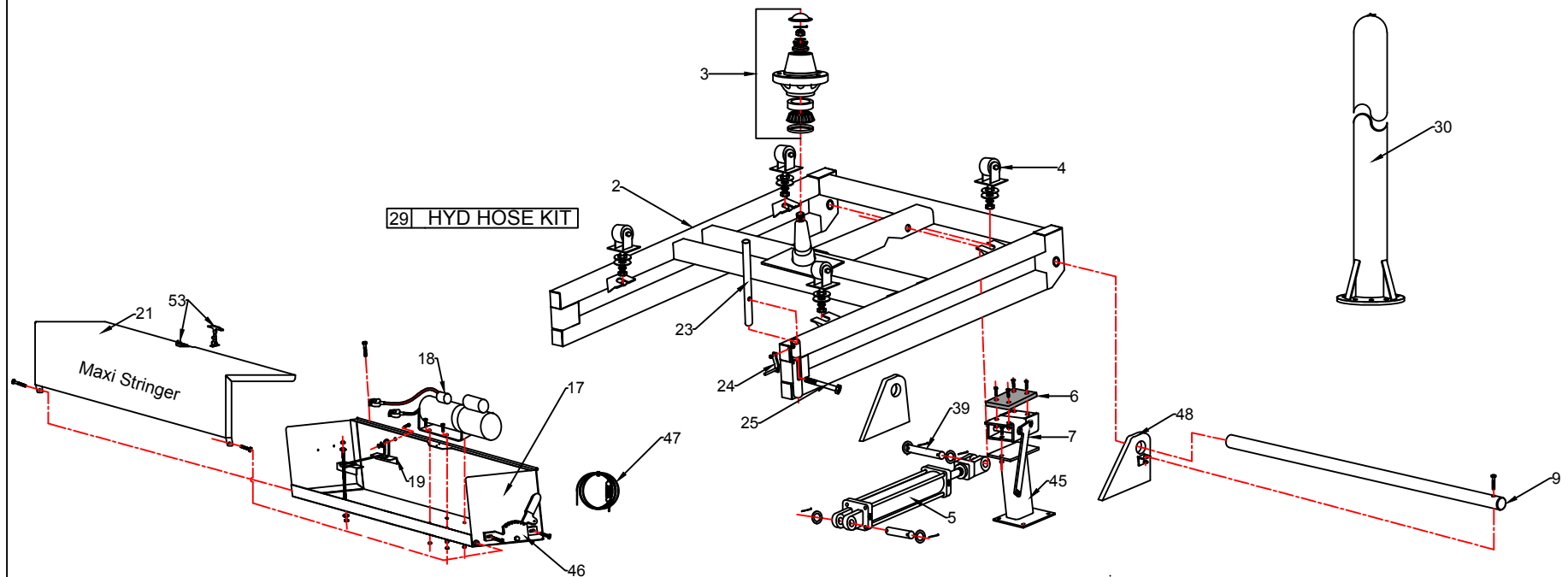

UNLESS OTHERWISE SPECIFIED
ALL DIMENSIONS ARE IN INCHES.

.X ±.06
.XX ±.03
.XXX ±.010
ANGLES ±2°

BREAK ALL SHARP CORNERS.

ALL INFORMATION CONTAINED IN THIS DOCUMENT IS PROPRIETARY TO AGRI DRAIN CORP. DUPLICATION OR TRANSMITTAL OF THIS DOCUMENT IS STRICTLY PROHIBITED WITHOUT THE WRITTEN CONSENT OF AGRI DRAIN CORP.

ITEM	QTY	ITEM DESCRIPTION	PART NO.
<p>Agri Drain CORPORATION</p> <p><i>America's Most Complete Supplier of Water Management Products</i></p> <p>P.O. Box 458 - 1462 340th St. - Adair, IA 50002 - Ph: 1-800-232-4742 - Fax 1-800-282-3353 - www.agridrain.com</p>			
<p>TITLE</p> <p>MAXI PICKUP MOUNT STRINGER</p>			
DATE: 11JUL11	DRAWN BY: J MOORE	PART NO.	REV.

PART NO.	REV.	CO. AGRI DRAIN CORP.	MATERIAL:
----------	------	----------------------	-----------

REVISIONS			
REV	DESCRIPTION	DATE	BY

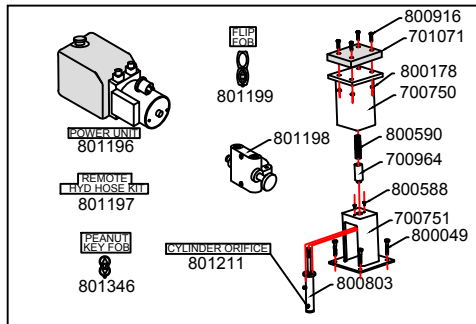

REMOTE OPTION

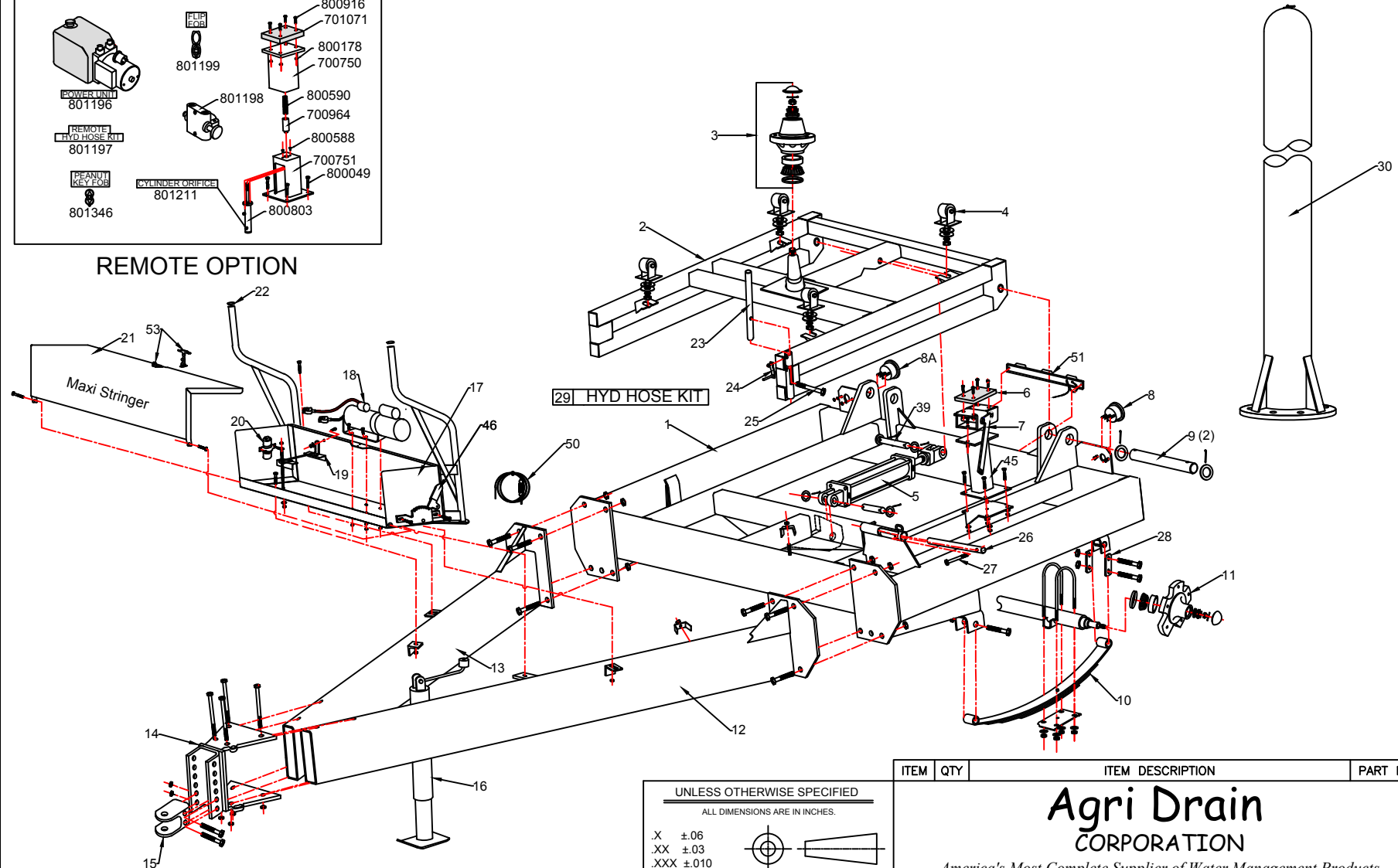

UNLESS OTHERWISE SPECIFIED
ALL DIMENSIONS ARE IN INCHES.

X ±.06
XX ±.03
XXX ±.010
ANGLES ±2°

BREAK ALL SHARP CORNERS.

ALL INFORMATION CONTAINED IN THIS DOCUMENT IS PROPRIETARY TO AGRI DRAIN CORP. DUPLICATION OR TRANSMITTAL OF THIS DOCUMENT IS STRICTLY PROHIBITED WITHOUT THE WRITTEN CONSENT OF AGRI DRAIN CORP.

ITEM	QTY	ITEM DESCRIPTION	PART NO.
<p>Agri Drain CORPORATION</p> <p><i>America's Most Complete Supplier of Water Management Products</i></p> <p>P.O. Box 458 - 1462 340th St. - Adair, IA 50002 - Ph: 1-800-232-4742 - Fax 1-800-282-3353 - www.agridrain.com</p>			
<p>TITLE</p> <p>HD, SINGLE TRAILER PARTS</p>			
DATE:24DEC09	DRAWN BY: J MOORE	PART NO.	REV.

PART NO.	REV.	CO. AGRI DRAIN CORP	MATERIAL:
----------	------	---------------------	-----------

REVISIONS			
REV	DESCRIPTION	DATE	BY

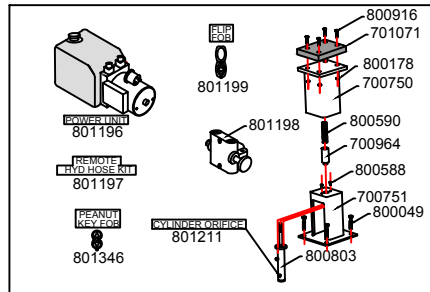

REMOTE OPTION

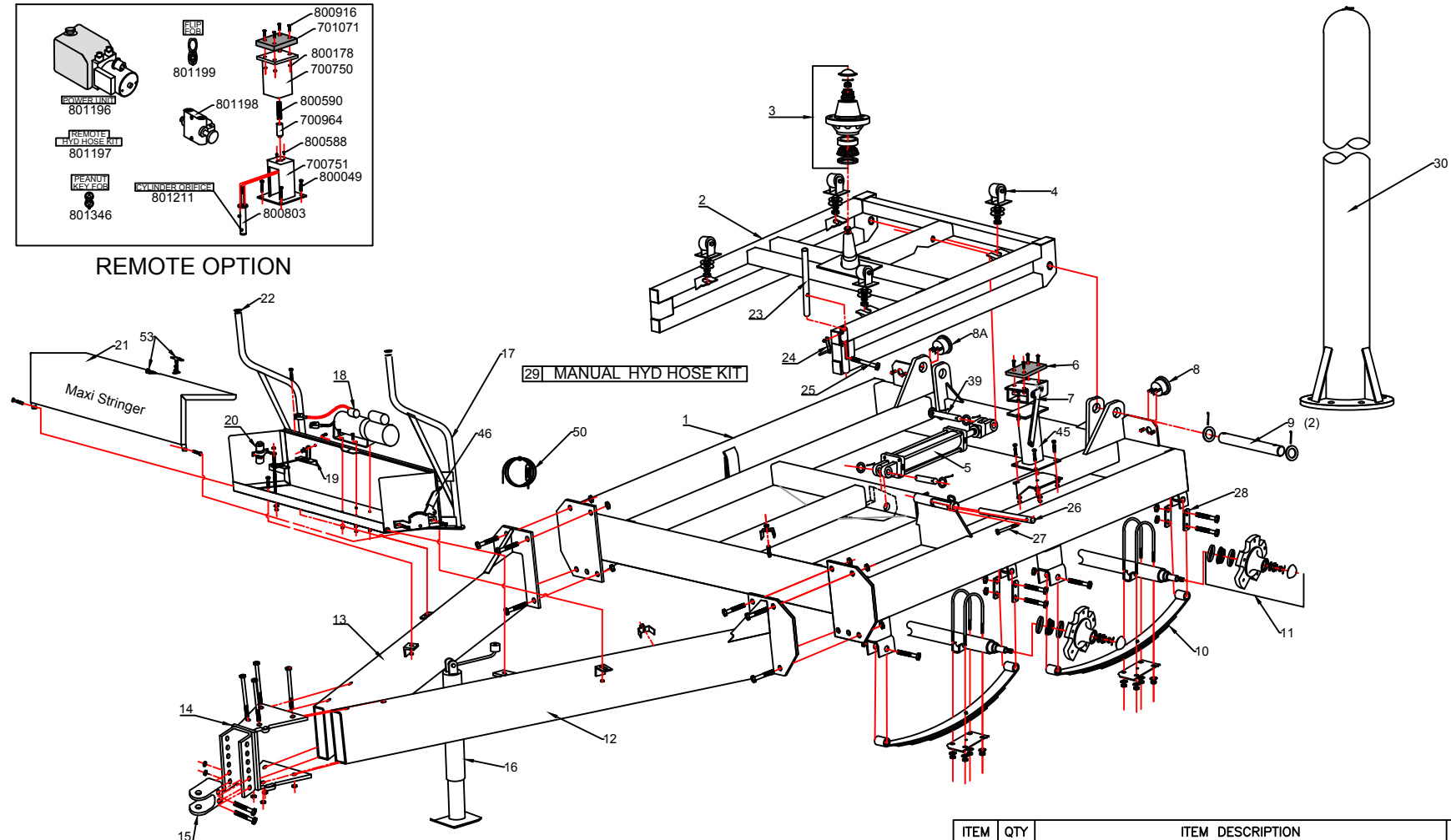

UNLESS OTHERWISE SPECIFIED
ALL DIMENSIONS ARE IN INCHES.

X ±.06
XX ±.03
XXX ±.010
ANGLES ±2°

BREAK ALL SHARP CORNERS.

ALL INFORMATION CONTAINED IN THIS DOCUMENT IS PROPRIETARY TO AGRI DRAIN CORP. DUPLICATION OR TRANSMITTAL OF THIS DOCUMENT IS STRICTLY PROHIBITED WITHOUT THE WRITTEN CONSENT OF AGRI DRAIN CORP.

ITEM	QTY	ITEM DESCRIPTION	PART NO.
<p>Agri Drain CORPORATION</p> <p><i>America's Most Complete Supplier of Water Management Products</i></p> <p>P.O. Box 458 - 1462 340th St. - Adair, IA 50002 - Ph: 1-800-232-4742 - Fax 1-800-282-3353 - www.agridrain.com</p>			
<p>TITLE</p> <p>HD, TANDEM TRAILER PARTS</p>			
DATE: 29DEC09	DRAWN BY: J. MOORE	PART NO.	REV.

PART NO.	REV. B	CO. AGRI DRAIN CORP.	MATERIAL:
----------	--------	----------------------	-----------

REVISIONS			
REV	DESCRIPTION	DATE	BY
A	CHG: PART NO. 801157	11SEP14	JM
B	CHG: REMOVE PART #32 AND USE TWO PART #33 ON PICKUP MOUNT VERSION	10JUL19	JM

DETAIL B (EIGHT REQUIRED)

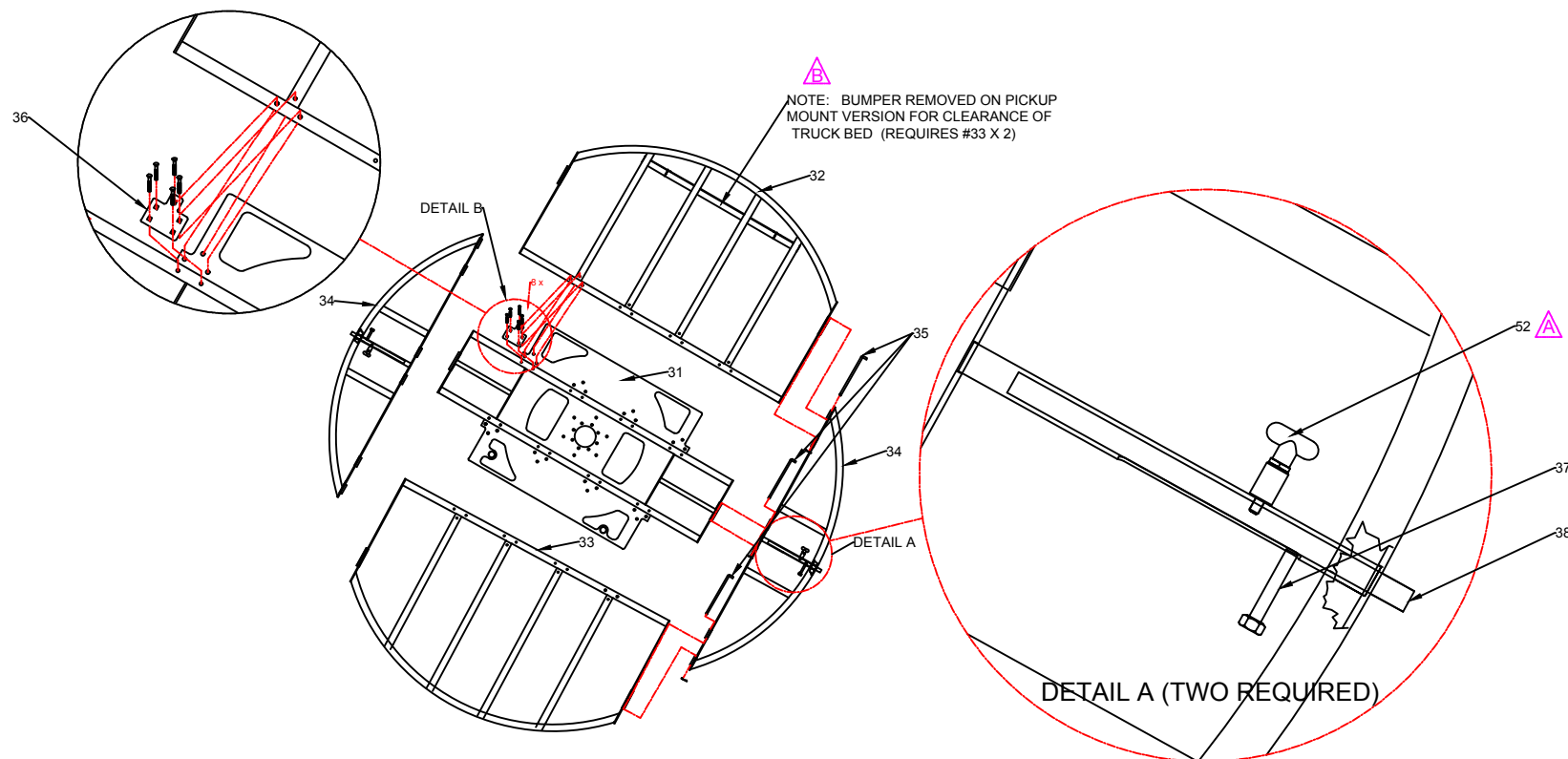

UNLESS OTHERWISE SPECIFIED
ALL DIMENSIONS ARE IN INCHES.

X ±.06
XX ±.03
XXX ±.010
ANGLES ±2°
BREAK ALL SHARP CORNERS.

ALL INFORMATION CONTAINED IN THIS DOCUMENT IS PROPRIETARY TO AGRI DRAIN CORP. DUPLICATION OR TRANSMITTAL OF THIS DOCUMENT IS STRICTLY PROHIBITED WITHOUT THE WRITTEN CONSENT OF AGRI DRAIN CORP.

ITEM	QTY	ITEM DESCRIPTION	PART NO.
<p>Agri Drain CORPORATION America's Most Complete Supplier of Water Management Products P.O. Box 458 - 1462 340th St. - Adair, IA 50002 - Ph: 1-800-232-4742 - Fax 1-800-282-3353 - www.agridrain.com</p>			
<p>TITLE MAXI STRINGER TABLE PARTS BREAKDOWN</p>			
DATE: 01JUL09	DRAWN BY: J MOORE	PART NO.	REV. B

G3-H13

Hydraulic Wireless Control System

The receiver module should be located in an area where the back-up switches will be accessible without the use of the transmitter. Mounting the receiver module within cabinetry works well. **However, if you are mounting the module within a steel compartment it is recommended that you drill a 1/2" hole in the steel, feed the antenna in (screw the end to the Receiver Module), & mount the top of the antenna to the outside of the steel box.**



- Mount antenna using self adhesive strip or a #8 screw (not included).

Typical range with the wireless key fob is 50-100ft, depending on where the receiver module is mounted. The receiver module & transmitter are water resistant. All electrical connections that are made to the control box should be made with properly sized electrical butt connectors. All wiring should be routed in areas that will protect it from road hazards and sharp edges. The receiver module should be installed so that the electrical connections are fully insulated and protected from objects that may come in contact with them causing an electrical short. All connecting wires should be the same size as the wires on the receiver (14/16-gauge stranded copper wire).

BATTERY WIRING - INSTALLATION PROCEDURE:

- 1) **RED** 14-Gauge Wire (Main 12volt +dc power) - Connected in-line with this wire is a **10-amp Fuse**. Connect this red wire to the battery positive terminal. *The fuse is installed within 18" of the battery and may be installed in the battery enclosure or compartment, provided this compartment is well ventilated. This system can handle 12 volt dc input. The Receiver Module's LED will turn from Green to Red when the trailer battery is below 9-volts.*
- 2) **BLACK** 14-Gauge Wire (Ground 12volt -dc) - Connect this black wire to the battery negative terminal. *Improper grounding will cause malfunctions. Be sure ground is clean.*

PUMP WIRING - INSTALLATION PROCEDURE:

POWER-UP, POWER-DOWN (Wiring for a 4 wire switch)

Note: Look at your factory wiring at the end of your up/down switch. If you have 4 wires use these instructions.

- 3) **ORANGE** 16-Gauge Wire (Common)(12volt for pump up&down) - Connect this wire (12volt output) to the trigger side of the pump solenoid switch. *This pin will show 12volts only when the trailer is being raised & lowered. Follow the factory switch wiring. The solenoid is the round part with many wires connected to it. Including the 12volt positive battery cable. It will be the smaller of the two pins that the factory switch wiring is attached to.*
- 4) **BLUE** 16-Gauge Wire (12volt output to raise trailer) - Connect this wire (12volt output) to the UP side of the pump solenoid valve. *This will usually be a square box about 2" square. It's usually on the pump or near it. It will have 1 or 2 wires on it. (If the pump has only 1 square box valve, you have a single solenoid pump. Please disregard this step and skip to terminal #5). Follow the factory switch wiring. Hook up to the same wire that the factory switch is hooked up too. This wire will show 12volts only when the trailer is being raised.*
- 5) **GRAY** 16-Gauge Wire (12volt output to lower trailer) - Connect this wire (12volt output) to the DOWN side of the pump solenoid valve. *This will usually be a second square box about 2" square. It's usually on the pump or near it. It will have 1 or 2 wires on it. Follow the factory switch wiring. Hook up to the same wire that the factory switch is hooked up too. This wire will show 12volts only when the trailer is being lowered.*

POWER-UP, GRAVITY-DOWN (Wiring for a 3 wire switch)

Note: Look at your factory wiring at the end of your up/down switch. If you have 3 wires use these instructions.

- 3) **ORANGE** 16-Gauge Wire (Common) - Not used. *If you have a harness, do not connect this wire. Clip the end off and tape up the end with electrical tape. If this wire touches any metal when unit is activated the unit will short out.*
- 4) **BLUE** 16-Gauge Wire (12volt output to raise trailer) - Connect this wire (12volt output) to the UP side of the pump solenoid switch. *This pin will show 12volts only when the trailer is being raised. Follow the factory switch wiring. The solenoid is the round part with many wires connected to it. Including the 12volt positive battery cable. It will be the smaller of the two pins that the factory switch wiring is attached to.*
- 5) **GRAY** 16-Gauge Wire (12volt output to lower trailer) - Connect this wire (12volt output) to the DOWN side of the pump solenoid valve. *This will usually be a square box about 2" square. It's usually on the pump or near it. It will have 1 or 2 wires on it. Follow the factory switch wiring. Hook up to the same wire that the factory switch is hooked up too. This wire will show 12volts only when the trailer is being lowered.*

OPERATION:

- Depress the on/off button on the transmitter, to activate. The blue light on the top should turn on. The transmitter should be in the off position when the unit is not in use. This transmitter has a safety time-out feature. When the unit was active and then not used in 1-minute it will automatically turn off. Just hit the on/off button to turn it back on!
- On the transmitter, depress & hold the Extend Button to raise the trailer. Depress & hold the Retract Button to lower the trailer.
- The switch mounted on the receiver module will function the same as the transmitter buttons. The tethered controller, which is usually supplied with the hydraulic pump, will also function to control the hydraulic system. Installation of the tethered system is not required, and can be discarded.

HOW TO LEARN A TRANSMITTER:

- 1) Enter learn mode: Push & hold the on/off button on the Receiver Module until the LED starts to flash, then release the button
- 2) Push & hold the on/off button on the Transmitter until the LED on the Receiver Module comes on constant. Release the on/off button. The Transmitter is now "learned".
- 3) Option: Learn another transmitter by repeating steps 1 & 2. Note: The Receiver Module exits the "learn mode" after each transmitter is learned. You can learn up to 8 transmitters.
- 4) To clear all transmitters out of the Receiver Module: Push & hold the on/off button on the Receiver Module for 10 Seconds.

G3-H13

Hydraulic Wireless Control System

1 Power-Up, Power-Down Double Acting Solenoid Installation

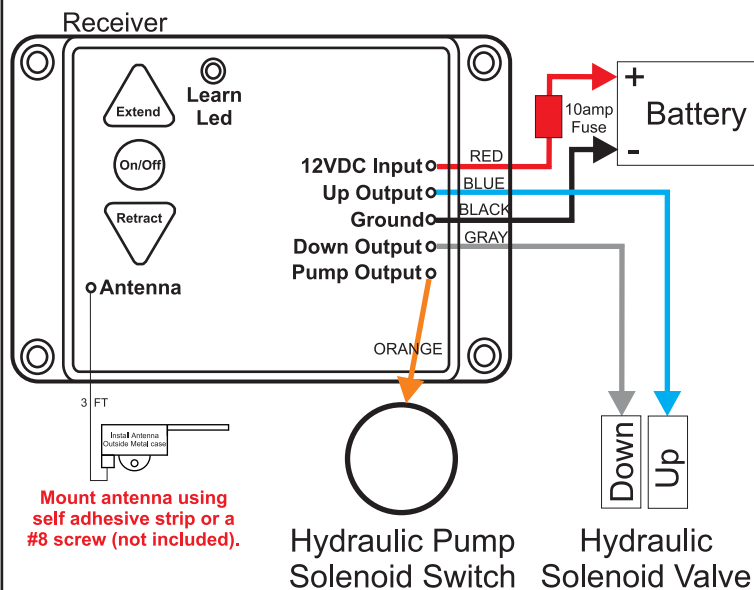

2 Power-Up, Power-Down Single Solenoid Installation

With single Hydraulic solenoid installation use either the Blue or Gray only, depending on system.

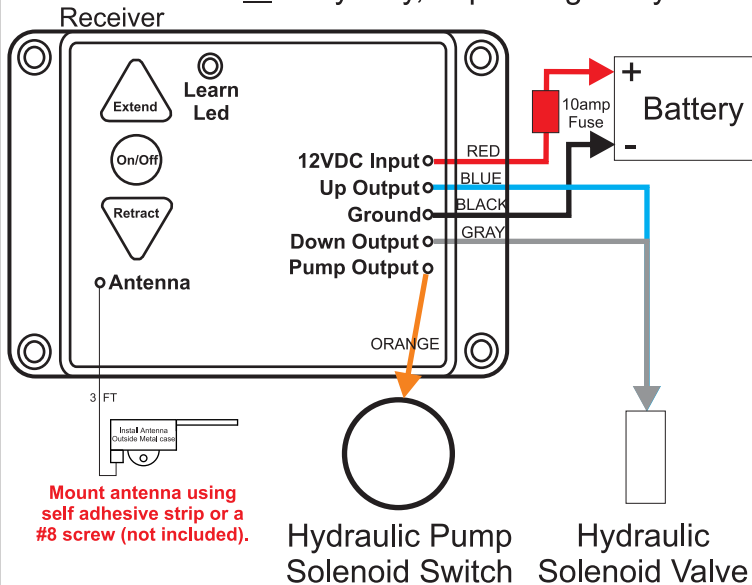

3 Power-Up, Gravity-Down Single Solenoid Installation

With single Hydraulic solenoid installation use the Blue and Gray wires only.

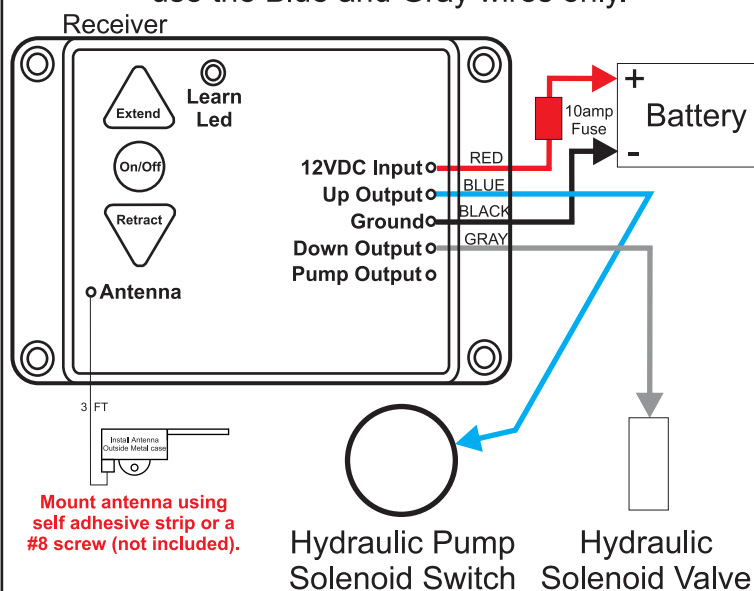

Transmitter

Function:

When the **Extend** button is depressed the **Orange & Blue** wires are powered with 12VDC.

When the **Retract** button is depressed the **Orange & Gray** wires are powered with 12VDC.

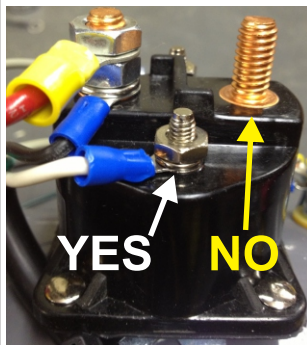

Solenoid Switch

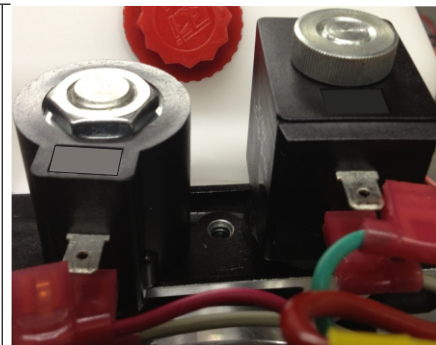

Solenoid Valve

For further assistance,
please feel free to contact us.

Agri Drain Corporation

1462 340th Street

Adair, IA 50002

Ph: (800) 232-4742

Fax: (800) 282-3353

www.agridrain.com

Agri Drain
CORPORATION