

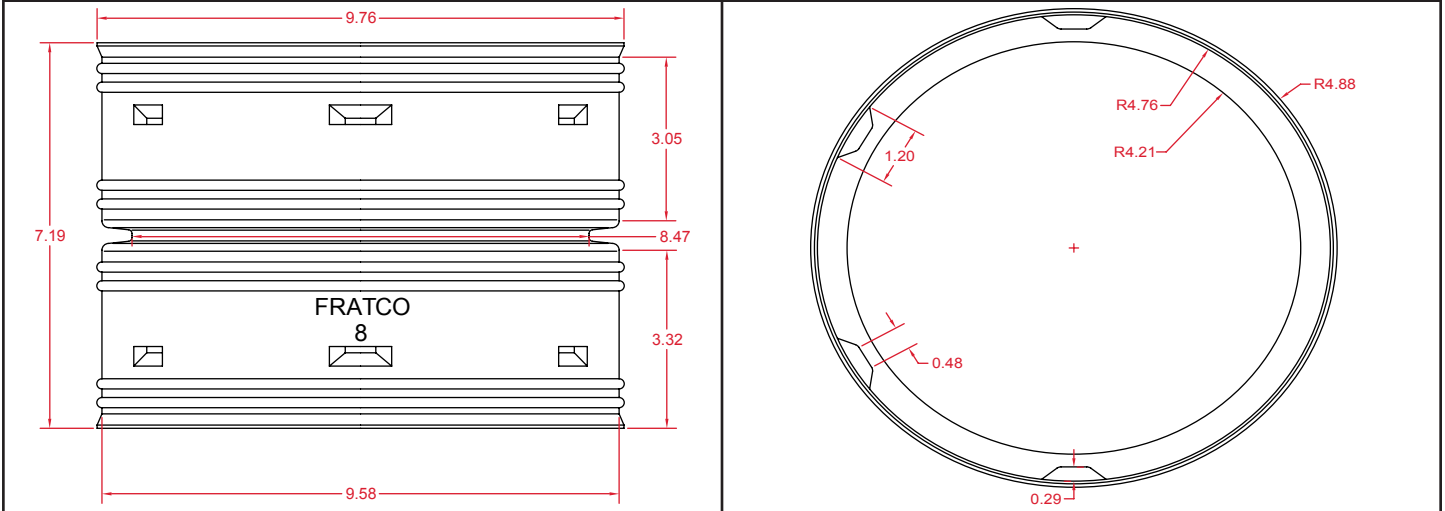

FITTING NUMBER	
40081200	
FITTING	SIZE
SNAP COUPLER	8"

MEASUREMENTS



PART WEIGHT
280 grams (+/- 20 grams)

PART WALL DISTRIBUTION
.07"

These specifications are held in standard according to ASTM F667 - Standard Specification for Polyethylene Plastics Pipe and Fittings material.